

Microdot Marking

- * Suitable for individual components, as well as small, medium and mass production.
- * The universal, independently programmable marking system.
- * Permanent, direct part marking within seconds.
- * Easy to use with our PC-based "Schillmarker" Software.
- * Highly versatile marking.
- * Sturdy and reliable.



A class better!



- The impact system enables individual marking depths and low component stress because of automatic vertical compensation.
- Fonts, symbols and drawings can be "pressed" in through fast impact of the needle.
- Cracks, deformations, tensions and breaks can be avoided by the controlled marking strength of the needle.
- Our "Schillmarker" Software allows for all marking possibilities. It's integration into conveyor systems are standard.

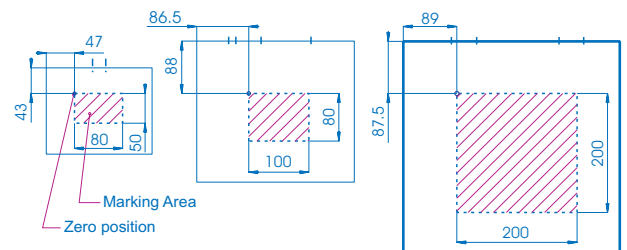

Marking area x / y	80 x 50	100 x 80	200 x 200	Control unit
Marking speed	1 - 200 mm/s			
Traversing speed	max. 250 mm/s			
Marking head orientation	can be positioned directly			
Marking resolution	0,025 mm, in both x and y axis			
Character height	up to 0,1 mm free scaling			
Marking frequency	max. 100 Hz			
Impact pressure	Adjustable			
Height adjustment of z-axis	+/- 3 mm			
Air requirements	300 l/min			
Working pressure	max. 6 bar			
Dimensions (W,H,D) in mm	176 x 246 x 145	262 x 189 x 237	360 x 189 x 356	310 x 100 x 200
Weight in kg	8	12,3	15,7	4,8
Power supply	115/230 VAC +/- 20% 50/60 Hz			
Diagnostic system	LED display			
Buffer capacity	200 KB (Optional max. 450 KB)			
PC Interface	RS 232 C			
Graphic options	Data-processing: HPGL-format with standard programs (CorelDraw, ACAD etc.)			

Accessories

Automatic rotary fixture

Art.-Nr.: 66.49000.0

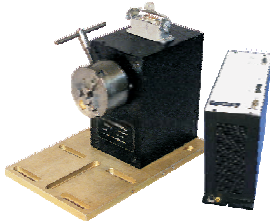

- Part diameter: **max. 97mm**
- Part admission: **three-jaw hand operated chuck**
- Peak height: **125mm**
- Additional control unit
- Base for fastening rotary fixture incl. t-slots
- Optional: Pneumatic chuck with rotary distributor

Remote control with fine pressure adjustment

Art.-Nr.: 66.72011.2

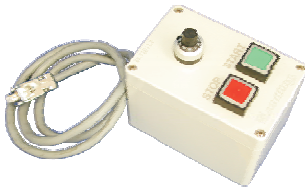

- Function keys: **Start and Stop**
- Pressure adjustment: **10 course potentiometer**
- Other optional remarks:
- BCD-Switch for automatic job choice
- Key switch as initialization routine

Needle Set for better results

Art.-Nr.: 66.64SET.3



- Light replacement needles with 60° / 90° / 118°
- normal piston and short piston, with appropriate spring
- o-rings, washers and allen-key

Needle assemblies complete

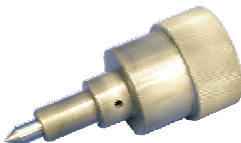

Heavy
Needle assembly \varnothing 6mm
For deep markings
Standard angle of the tip: 60°
Other angles: 90° / 118°
Art.-Nr.: 66.62150.6S

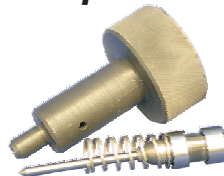

Light
Needle assembly \varnothing 3mm
For normal markings
Standard angle of the tip: 60°
Other angles: 90° / 118°
Art.-Nr.: 66.62032.3S

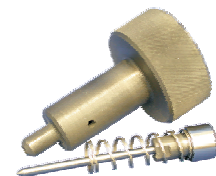

Light, soft
Needle assembly \varnothing 3mm
For fine markings
Standard angle of the tip: 60°
Other angles: 90° / 118°
Art.-Nr.: 66.62132.3S

Tungsten carbide exchange needles



Heavy
Replacement needle \varnothing 6mm
Available angles:
60° - Art.-Nr.: 66.64060.6S
90° - Art.-Nr.: 66.64090.6S
118° - Art.-Nr.: 66.64118.6S



Light
Replacement needle \varnothing 3mm
Available angles:
60° - Art.-Nr.: 66.64060.3S
90° - Art.-Nr.: 66.64090.3S
118° - Art.-Nr.: 66.64118.3S

Needle extension

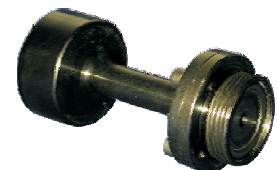

To adjust the spacer distance from the needle tip and the marking head. Spacer extension: 70mm
Art.-Nr.: 66.60007.3